

STAGE

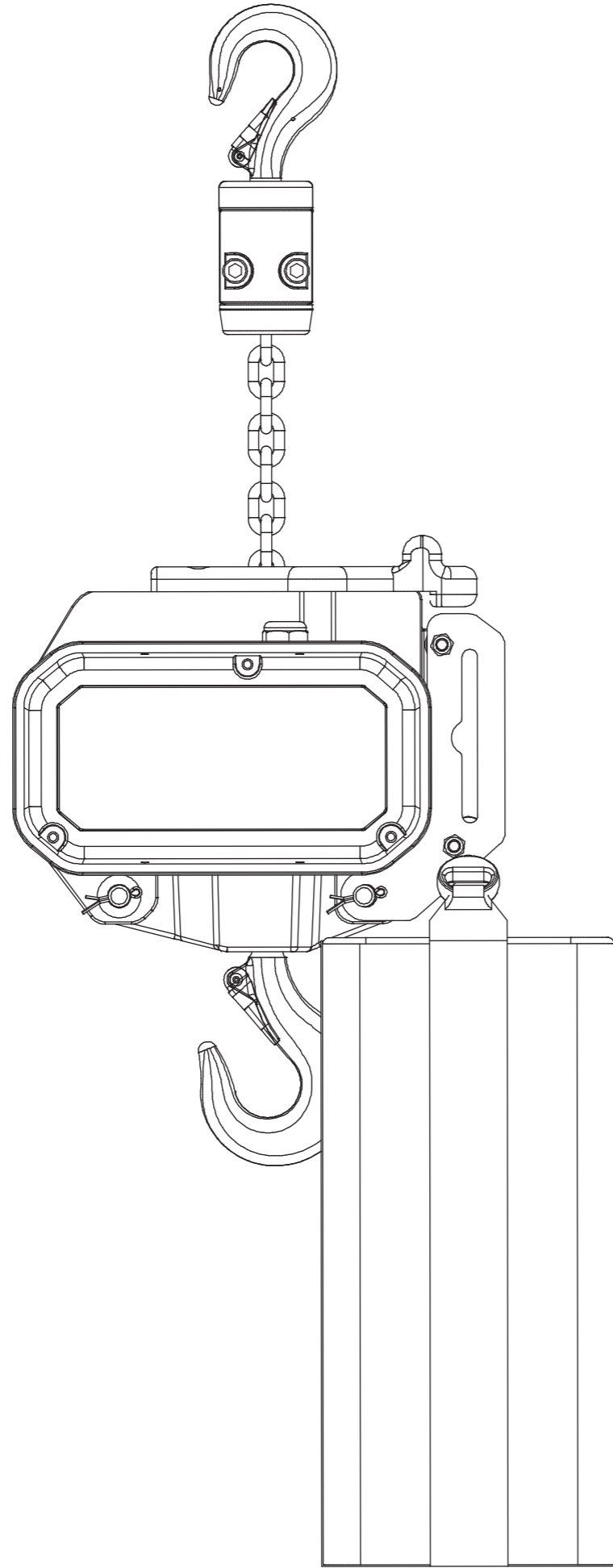

LIFTKET

TECHNICAL SPECIFICATIONS

TECHNICAL SPECIFICATIONS

Load D8 (1)	Load D8 Plus (2)	Load C1 (3)	Model	Speed at 50Hz	Speed at 60Hz	Chain size	Chain weight	FEM hoist D8	ED	Switches	Motor type	Power at 60Hz	Rpm at 60Hz	IP Standard	IP66 Option	Gear limit switches possible	Gear limit switches prepared	Brake no.
<i>kg</i>	<i>kg</i>	<i>kg</i>		<i>m/min</i>	<i>ft/min</i>	<i>mm</i>	<i>kg/m</i>		<i>%</i>	<i>S/h</i>		<i>kW</i>	<i>1/min</i>					
320	-	-	MB1.1/25B	4	16	4x12	0,35	1Bm/M3	40	240	56G4E	0,26	1632	55	-	-	-	1
320	250	200	SB1.1/81B	4	16	4x12	0,35	-	40	240	56G4E	0,26	1632	55	-	-	-	2
500	-	-	030/20 MB	4	16	5,2x15	0,55	1Am/M4	40	240	63G4	0,44	1656	55	-	✓ (4)	-	1
500	-	320	030/10 SB	4	16	5,2x15	0,55	1Am/M4	40	240	63G4	0,44	1656	55	-	✓ (4)	-	2
-	400	-	030/10 SB	4	16	5,2x15	0,55	-	40	240	63G4	0,44	1656	55	-	✓ (4)	-	2
500	-	-	030/22 MB	8	32	5,2x15	0,55	1Bm/M3	40	240	63G2	0,84	3348	55	-	✓ (4)	-	1
500	320	320	030/12 SB	8	32	5,2x15	0,55	1Bm/M3	40	240	63G2	0,84	3348	55	-	✓ (4)	-	2
500	320	320	SK030/10	4	16	5,2x15	0,55	1Am/M4	40	240	63G4E	0,44	1656	55	✓	✓	✓	2
-	400	-	SK030/10	4	16	5,2x15	0,55	-	40	240	63G4E	0,44	1656	55	✓	✓	✓	2
-	500	320	SK030/76	4	16	P 5,4x15	0,59	-	40	240	63G4E	0,44	1656	55	✓	✓	✓	2
500	320	250	SK070/19	20	80	7x22	1,10	1Bm/M3	40	240	80G2E	2,64	3420	55	✓	✓	✓	2
1000	-	-	MB4.3/20T	4	16	7x22	1,10	1Bm/M3	25	150	71G4E	0,96	1632	54	-	✓	✓	1
1000	500	500	SB4.1/12J	4	16	7x22	1,10	1Bm/M3	25	150	71G4E	0,96	1632	54	-	✓	✓	2
1000	630	630	SK070/16	4	16	7x22	1,10	2m/M5	40	240	80G4E	1,32	1692	55	✓	✓	✓	2
-	750	-	SK070/16	4	16	7x22	1,10	-	40	240	80G4E	1,32	1692	55	✓	✓	✓	2
1000	1000	750	SK070/76	4	16	P 7,4x21,1	1,30	2m/M5	40	240	80G4E	1,32	1692	55	✓	✓	✓	2
1000	630	500	SK070/17	8	32	7x22	1,10	1Bm/M3	40	240	80G2E	2,64	3420	55	✓	✓	✓	2
1000	630	500	SK070/13	10	40	7x22	1,10	1Bm/M3	40	240	80G2E	2,64	3420	55	✓	✓	✓	2
1000	630	500	SB6.1/12P	16	64	9x27	1,80	2m/M5	40	240	90L2E	3,60	3420	54	-	✓	✓	2
1600	1000	1000	SB6.1/17P	4	16	9x27	1,80	1Bm/M3	25	150	90L4E	2,64	1704	54	-	✓	✓	2
2500	1250	1250	SB8.2/10U	4	16	11x31	2,70	1Bm/M3	25	150	90L4E	2,64	1704	54	-	✓	✓	2
2500	1250	1250	SB8.3/10V	8	32	11x31	2,70	1Bm/M3	25	150	90L2E	4,32	3420	54	-	✓	✓	2
3200	2000	1350	110/14 SB	4	16	11,3x31	2,85	2m/M5	60	240	90L4E	2,64	1704	55	-	✓	-	2

(1) Acc. to DGUV V54

(2) Acc. to SQP2 2018:10 (8:1 static)

(3) Acc. to DGUV V17 / DIN 56950 (8:1 dynamic)

(4) Dimension B / C on request

Bestsellers

Subject to change without notice.

DIMENSIONS

CHAIN HOIST

Model	Hook tackle 1/1	Hook block 2/1	Hook suspension (Motor)	Body weight (5)	A	B direct control	B low volt. Control	C direct control	C low volt. Control	G susp. Eye	G hook susp.	ø N	J 1/1	J 2/1	J hook susp.
				kg	mm	mm	mm	mm	mm	mm	mm	mm	mm	mm	mm
MB1.1/25B	012-V	-	025-V	9,8	220	143	-	100	-	176	262	23	20	-	22
SB1.1/81B	012-V	-	025-V	10,2	220	206	206	100	233	176	262	23	20	-	22
030/20 MB	012-V	-	025-V	15,8	253	220	220	234	234	187	269	23	20	-	22
030/10 SB	012-V	-	025-V	17,5	253	220	220	234	234	187	269	23	20	-	22
030/10 SB	025-V	-	025-V	17,5	253	220	220	234	234	187	269	23	20	-	22
030/22 MB	012-V	-	025-V	15,3	253	220	220	234	234	187	269	23	20	-	22
030/12 SB	012-V	-	025-V	17	253	220	220	234	234	187	269	23	20	-	22
SK030/10	012-V	-	025-V	17	258	247	247	126	255	200	282	23	20	-	22
SK030/10	025-V	-	025-V	17	258	247	247	126	255	200	282	23	22	-	22
SK030/76	025-V	-	025-V	17	258	247	247	126	255	200	282	23	22	-	22
SK070/19	025-V	05-V	05-V	39	316	283	283	167	255	247	356	23	22	28	28
MB4.3/20T	025-V	05-V	05-V	24	295	183	183	184	257	226	336	23	22	28	28
SB4.1/12J	025-V	05-V	05-V	26	295	252	252	184	257	226	336	23	22	28	28
SK070/16	025-V	-	05-V	31	316	248	248	167	255	247	356	23	22	-	28
SK070/16	05-V	-	05-V	31	316	248	248	167	255	247	356	23	28	-	28
SK070/76	05-V	-	05-V	31	316	248	248	167	255	247	356	23	28	-	28
SK070/17	025-V	05-V	05-V	3	316	283	283	167	255	247	356	23	22	28	28
SK070/13	025-V	05-V	05-V	39	316	283	283	167	255	247	356	23	22	28	28
SB6.1/12P	05-V	1-V	1-V	57	385	304	304	261	261	271	407	22	28	30	30
SB6.1/17P	05-V	1-V	1-V	57	385	304	304	261	261	271	407	22	28	30	30
SB8.2/10U	1-V	2,5-P	2,5-P	66	396	329	329	267	267	293	483	25	30	42	42
SB8.3/10V	1-V	2,5-P	2,5-P	66	396	329	329	267	267	293	483	25	30	42	42
110/14 SB	1-V	2,5-P	2,5-P	91	406	367	367	420	420	341	460	67	30	42	42

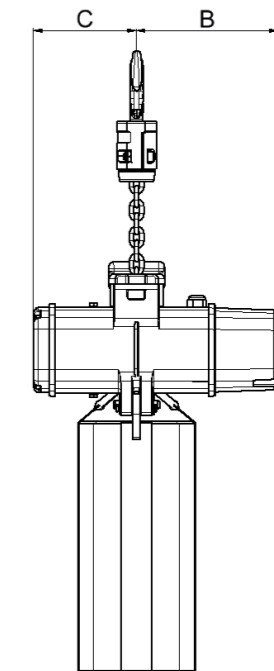
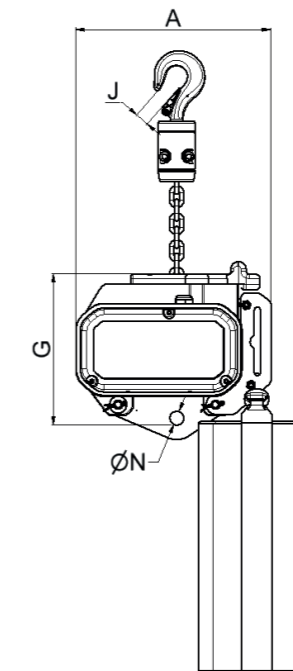

Chain Hoist with suspension eye

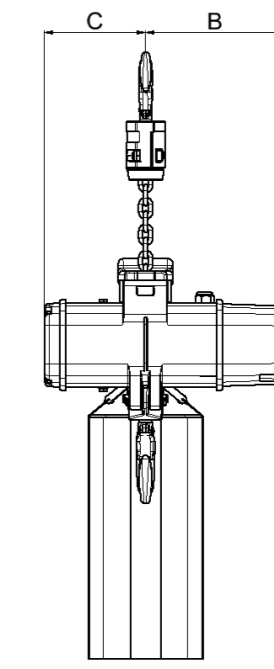
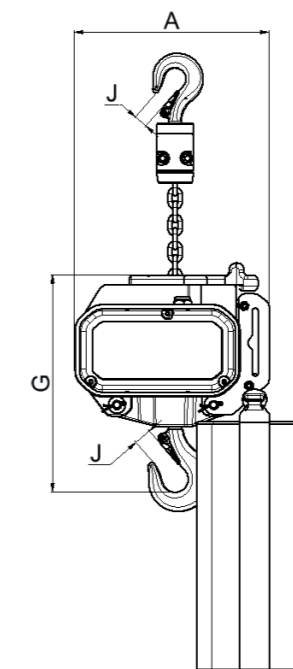

Chain Hoist with hook suspension

(5) Body weight without chain, hook and suspension, direct control

Subject to change without notice.

DIMENSIONS

FLIP BAG & HOOK

Hook no. DIN 15401 part 1	a1	a2	h1	b1	h2	b2	Permissible tolerances a1, a2, h1, b1, h2, b2
	<i>mm</i>	<i>mm</i>	<i>mm</i>	<i>mm</i>	<i>mm</i>	<i>mm</i>	<i>mm</i>
012	30	20	22	19	19	15	+2
025	36	22	28	22	24	19	+2
05	43	28	37	29	31	24	+3
1	50	30	48	38	40	32	+3
2,5	63	42	67	53	58	45	+3

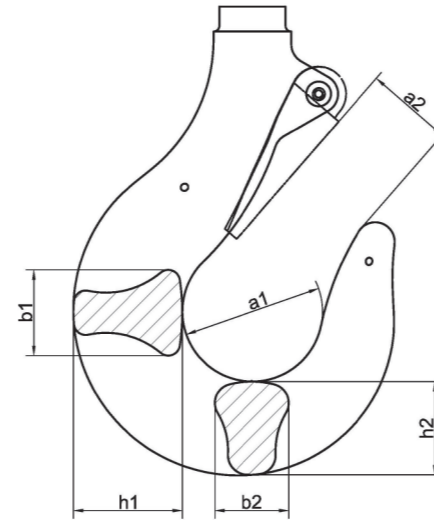

	Chain 4x12	Chain 5,2x15 P 5,4x15	Chain 7x22 P 7,4x21,1	Chain 9x27	Chain 11x31 11,3x31
<i>Chain length [m]</i>	<i>Height of chain bag [mm]</i>				
6	320	400	400	350	350
10	320	400	400	350	480
12	320	400	500	480	480
18	380	400	500	480	600
20	380	400	500	600	600
25	480	500	600	600	700
30	480	600	700	600	800
40	560	600	800	700	-
50	670	700	900	-	-

Subject to change without notice.

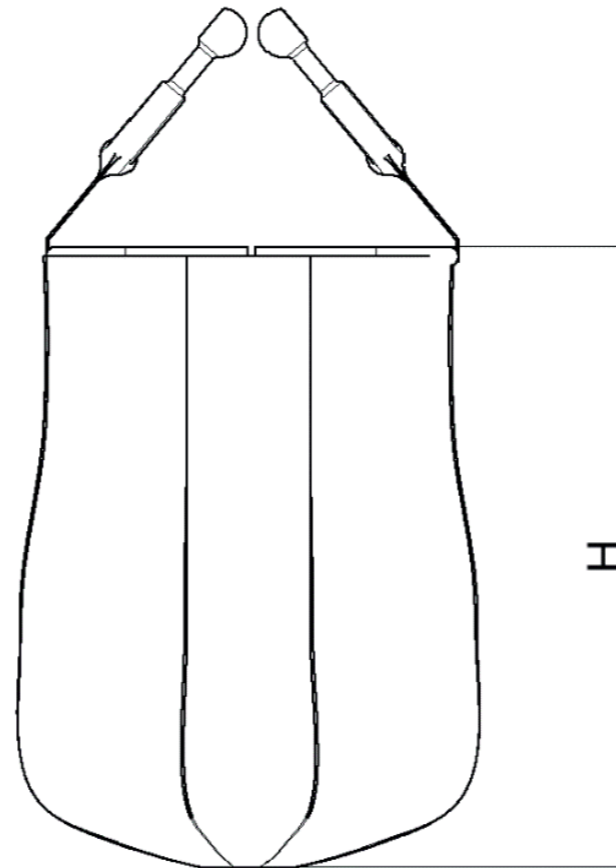

LIFTKET Entertainment Inc.
925 Newton Ave - #118
Quebec City, QC • Canada G1P 4M2

Mail: info@liftket-et.com
Web: www.liftket-et.com